



American Earth Anchors

The best screw you will have in the dirt™

americanearthanchors.com

QUICK REFERENCE

4ST-48TH | Specifications

4" steel arrowhead with 4' cable and thimble



Anchor

Galvanized steel

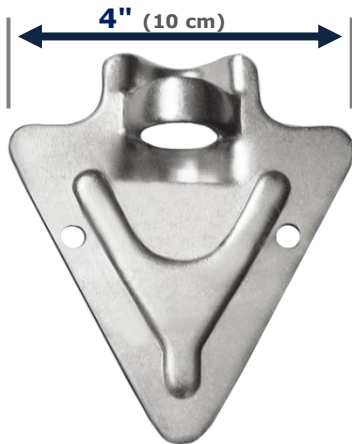

Cable

Galvanized steel aircraft cable

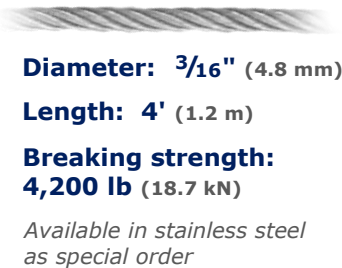

Thimble

Galvanized steel



Steel Arrowheads

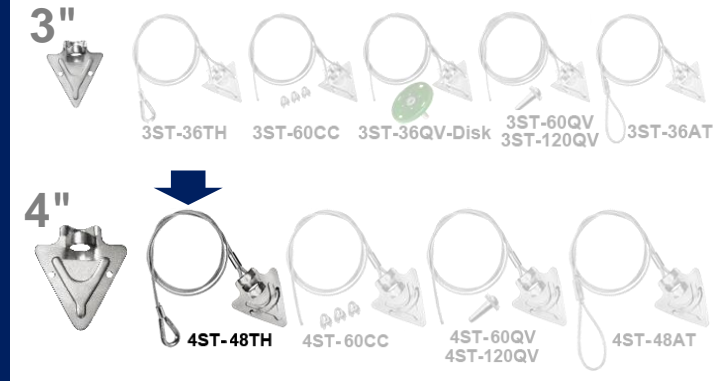

LOAD CAPACITY

Pullout strength at MINIMUM DEPTH 2 1/2' (.8 m)

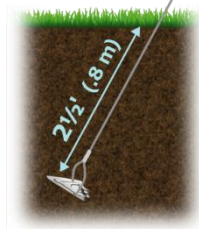

Soil Class 1	Soil Class 2	Soil Class 3	Soil Class 4	Soil Class 4
Hardpan Asphalt	Sandy gravel Very dense sand	Silty/clayey sand Silty gravel	Loose/med dense sands Loose sands Firm clays	Loose fine un- compacted sand
3,500 lb 15.6 kN	2,200 lb 9.79 kN	1,900 lb 8.45 kN	900 lb 4.00 kN	475 lb 2.11 kN

Soil classification per ASTM D-2487/2488

© 2018 American Earth Anchors
QR-4ST-48TH Mar 2018



American Earth Anchors
info@americanea.com
americanearthanchors.com

Contact us for CUSTOM WORK
Size, length, shape, material,
prototypes, cable assemblies



866-520-8511

+1 508-520-8511

4ST-48TH | Installation

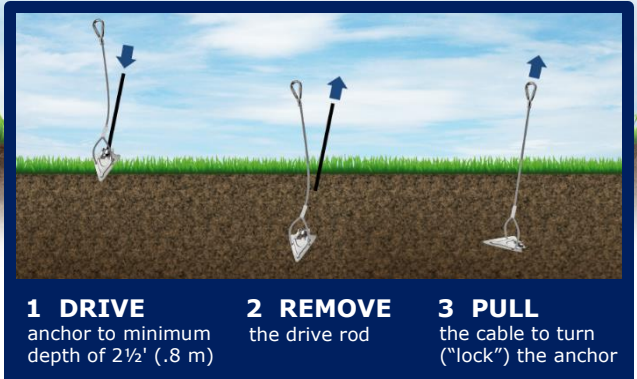

Into the ground

3' (.9 m) drive rod

3/4" (19 mm) diameter

DR-4ST



Locking the anchor



During locking, anchor will pull up as it turns, settles, and locks – depending on soil type, this can typically be 1-5 inches (3-13 cm)

SIMPLE PULL



LEVERAGE (Manual)

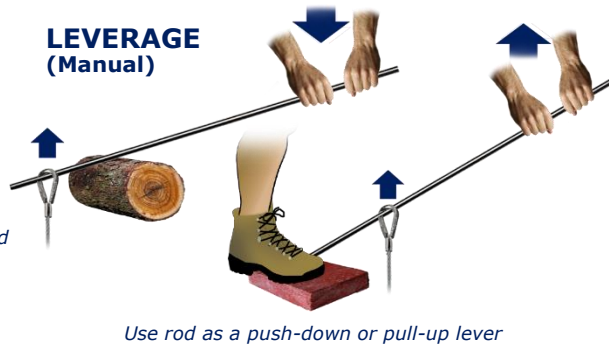

LEVERAGE (Mechanical)

Not usually needed for this size anchor



Through asphalt

Make slot through asphalt



Non-vertical load

Install at same angle as load for maximum pullout strength

