



# American Earth Anchors

The best screw you will have in the dirt™

americanearthanchors.com

QUICK REFERENCE

**4ST-60QV**  
**4ST-120QV**

Specifications

**4" steel arrowhead**  
with 5' or 10' cable and Quickvise



**Anchor**

Galvanized steel

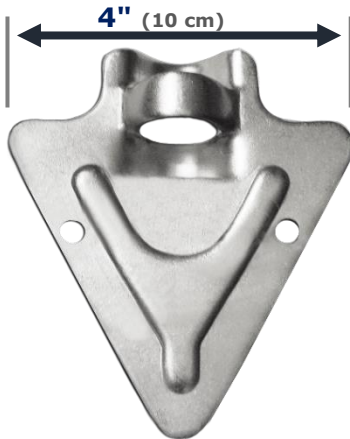

.74 lb (.34 kg) 1.2 lb (.54 kg)



**Cable**

Galvanized steel  
aircraft cable



Diameter: 3/16" (4.8 mm)

Length: 5' (1.5 m)  
10' (3 m)

Breaking strength:  
4,200 lb (18.7 kN)

Available in stainless steel  
as special order

**Quickvise**

Available separately  
as product QV316

Shell: Aluminum  
Jaws: Galvanized steel  
Spring: Stainless steel

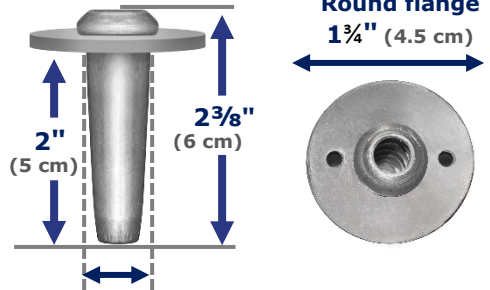

Hole diameter  
for shaft  
1 1/16" (2 cm)

## LOAD CAPACITY

Pullout strength at MINIMUM DEPTH 2 1/2' (.8 m)



Soil Class 1	Soil Class 2	Soil Class 3	Soil Class 4	Soil Class 4
Hardpan Asphalt	Sandy gravel Very dense sand	Silty/clayey sand Silty gravel	Loose/med dense sands Loose sands Firm clays	Loose fine un- compacted sand
<b>3,150 lb</b> 15.6 kN	<b>2,200 lb</b> 9.79 kN	<b>1,900 lb</b> 8.45 kN	<b>900 lb</b> 4.00 kN	<b>475 lb</b> 2.11 kN

Soil classification per ASTM D-2487/2488

## Steel Arrowheads

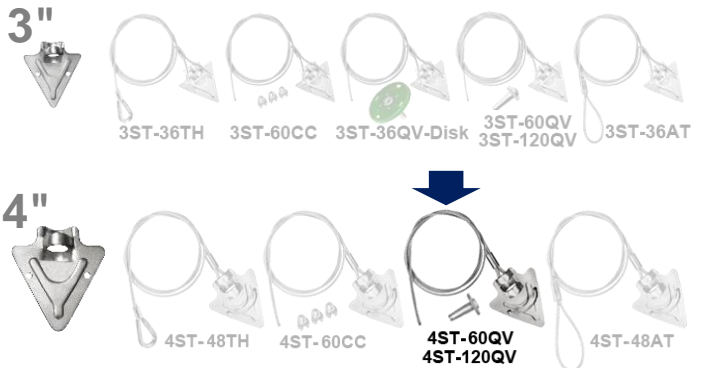

© 2018 American Earth Anchors  
QR 4ST-60QV-4ST-120QV Mar 2018



American Earth Anchors  
info@americanearthanchors.com  
americanearthanchors.com

Contact us for CUSTOM WORK

Size, length, shape, material,  
prototypes, cable assemblies



866-520-8511



+1 508-520-8511

# 4ST-60QV 4ST-120QV

## Installation

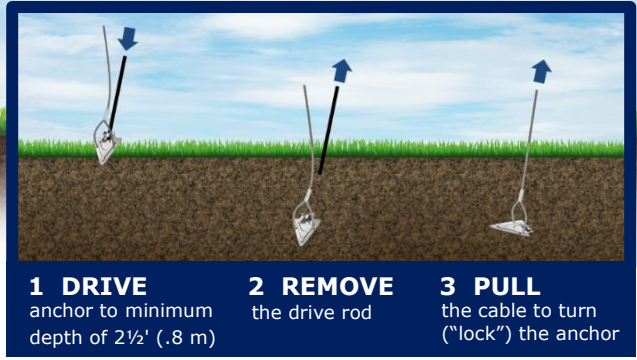

### Into the ground

3' (.9 m) drive rod

3/4" (19 mm) diameter

DR-4ST

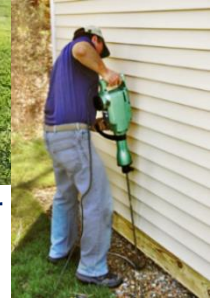

### Locking the anchor



During locking, anchor will pull up as it turns, settles, and locks. Depending on soil type, this can typically be 1-5 inches (3-13 cm).

#### SIMPLE PULL



#### LEVERAGE (Manual)

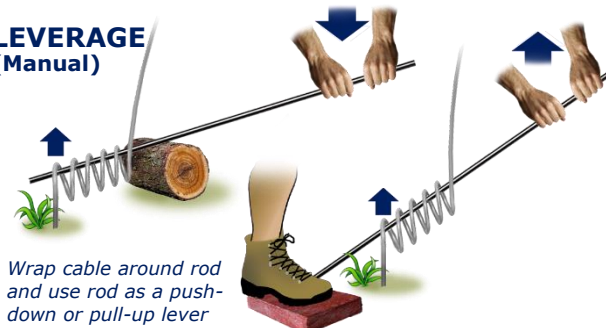

#### LEVERAGE (Mechanical)

Not usually needed for this size anchor



### Through asphalt

Make slot through asphalt



### Non-vertical load

Install at same angle as load for maximum pullout strength

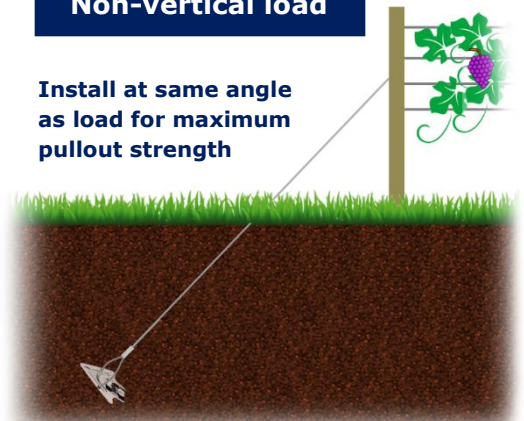

### Contact us for CUSTOM WORK

Size, length, shape, material,  
prototypes, cable assemblies



866-520-8511



+1 508-520-8511